



ΦΩΤΟΤΕΧΝΙΚΗ ΜΕΛΕΤΗ

J.M. Μεταμόρφωσης Σωτήρος Καμένων Βούρλων _Καθολικό Εσωτερικά

Installation :

Project number : ΜΕΤΑΜΟΡΦΩΣΗ ΚΑΘΟΛΙΚΟ

Customer :

Processed by :

Date : 11.05.2025

The following values are based on precise calculations performed on calibrated lamps and luminaires, and their configurations, whereby gradual, unavoidable deviations can occur in practice. All guarantee claims are excluded for the specified data.

This exclusion of liability applies irrespective of the legal grounds for both damages and consequential damages suffered by users and third parties.

Object :
Installation :
Project number : ΜΕΤΑΜΟΡΦΩΣΗ ΚΑΘΟΛΙΚΟ
Date : 11.05.2025

1 Luminaire data

1.1 not a Relux Member, Product (*4122C*)

1.1.1 Data sheet

Manufacturer: not a Relux Member

4122C Product

Luminaire data

Luminaire efficiency : 99.8%
Luminaire efficacy : 94.92 lm/W
Classification : A70 □ 100.0% ↑ 0.0%
CIE Flux Codes : 91 99 100 100 100
UGR 4H 8H : 26.3 / 26.3
Power : 9 W
Luminous flux : 854.3 lm

Dimensions : 49 mm x 91 mm x 49 mm

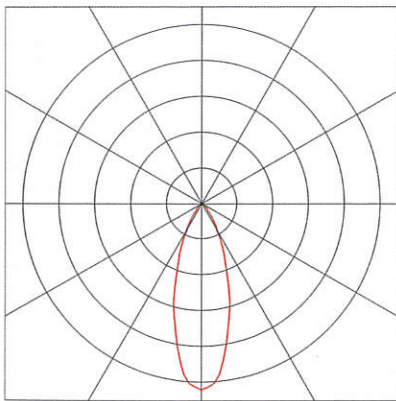

Equipped with

Quantity : 1
Designation : LED 9W
Colour : 3000
Luminous flux : 856 lm
Colour reproduction : 85

Το παρόν σχέδιο συνοδεύει
την με αριθ. πρωτ. 194108
ΥΠ. ΠΑΙΔΕΙΑΣ ΘΡ. ΠΟΛ. 341
ΔΑΒΜΜ/ 1/5/2025
Απόφαση.



Ο Προϊστάμενος της ΔΑΒΜΜ

Θεμιστοκλής Βλαχούλης
Αρχιτέκτων Μηχανικός με Α' βαθμό

Object :
Installation :
Project number : ΜΕΤΑΜΟΡΦΩΣΗ ΚΑΘΟΛΙΚΟ
Date : 11.05.2025

2 Room 1

2.1 Description, Room 1

2.1.1 Luminaire data/Room elements

Product data:

Type No.\Make

3	15 x	not a Relux Member
		Order No. : *4122C*
		Luminaire name : Product
		Equipment : 1 x LED 9W 9 W / 856 lm



Object :
 Installation :
 Project number : ΜΕΤΑΜΟΡΦΩΣΗ ΚΑΘΟΛΙΚΟ
 Date : 11.05.2025



2 Room 1

2.1 Description, Room 1

2.1.1 Luminaire data/Room elements

Floor with luminaire and sensor positions:

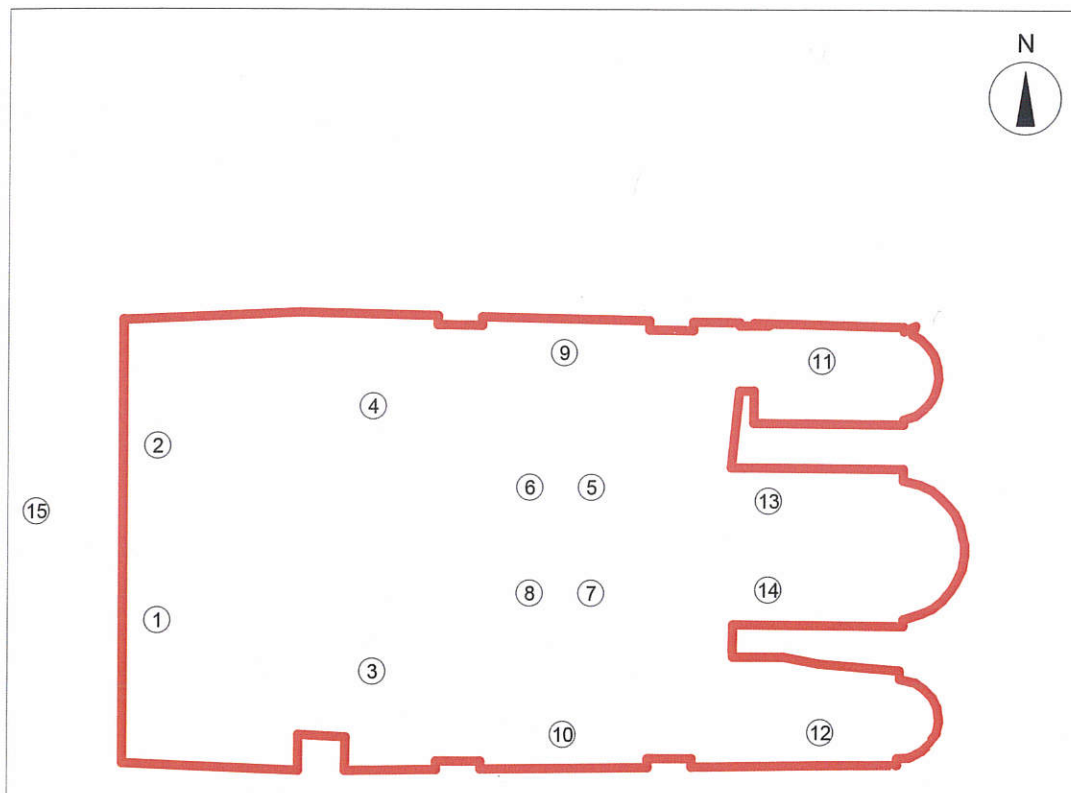

No.	Centre point			Rotation angle			Target coordinates		
	X [m]	Y [m]	Z [m]	Z [°]	C0 [°]	C90 [°]	Xa [m]	Ya [m]	Za [m]
not a Relux Member Product *4122C*									
1	0.56	-5.10	3.24	0.00	0.00	0.00	0.56	-5.10	0.00
3	4.23	-5.96	3.24	0.00	0.00	0.00	4.23	-5.96	0.00
4	4.23	-1.46	3.24	0.00	0.00	0.00	4.23	-1.46	0.00
11	11.86	-0.68	3.24	0.00	0.00	0.00	11.86	-0.68	0.00
12	11.86	-6.98	3.24	0.00	0.00	0.00	11.86	-6.98	0.00
13	10.96	-3.06	3.24	0.00	0.00	0.00	10.96	-3.06	0.00
14	10.96	-4.56	3.24	0.00	0.00	0.00	10.96	-4.56	0.00
9	7.47	-0.55	3.24	0.00	0.00	0.00	7.47	-0.55	0.00
10	7.47	-7.02	3.24	0.00	0.00	0.00	7.47	-7.02	0.00
5	7.95	-2.83	3.24	0.00	0.00	0.00	7.95	-2.83	0.00
7	7.95	-4.63	3.24	0.00	0.00	0.00	7.95	-4.63	0.00
6	6.89	-2.83	3.24	0.00	0.00	0.00	6.89	-2.83	0.00
8	6.89	-4.63	3.24	0.00	0.00	0.00	6.89	-4.63	0.00
2	0.56	-2.14	3.24	0.00	0.00	0.00	0.56	-2.14	0.00
15	-1.49	-3.26	6.50	0.00	0.00	0.00	-1.45	-3.29	0.00

Object :
 Installation :
 Project number : ΜΕΤΑΜΟΡΦΩΣΗ ΚΑΘΟΛΙΚΟ
 Date : 11.05.2025



2 Room 1

2.1 Description, Room 1

2.1.1 Luminaire data/Room elements

Measuring surface

No.	xm[m]	ym[m]	zm[m]	Length	Width	z axis	Rotation angle	
							L axis	Q axis
Ref. plane 1.1								
	13.32	-1.04	0.75	15.95	12.53	165.56	0.00	0.00
M 1.1 (W -0.03	-7.53	0.00	0.00	0.00	6.54	0.00	90.00	90.00
M 1.2 (W 2.97	-7.63	0.00	0.00	2.10	0.07	0.00	90.00	178.00
M 1.3 (W 5.32	-7.62	0.00	0.00	1.08	0.01	0.00	90.00	-179.29
M 1.4 (W 8.92	-7.58	0.00	0.00	1.99	0.02	0.00	90.00	-179.29
M 1.5 (V 11.82	-7.54	0.00	0.00	1.50	0.02	0.00	90.00	-179.29
M 1.6 (V 13.26	-5.17	0.00	0.00	2.03	0.01	0.00	90.00	179.60
M 1.7 (V 10.32	-2.48	0.00	0.00	2.05	0.02	0.00	90.00	-0.44
M 1.8 (V 13.26	-1.76	0.00	0.00	1.79	0.01	0.00	90.00	179.56
M 1.9 (V 10.70	-0.04	0.00	0.00	1.78	0.04	0.00	90.00	-1.30
M 1.10 (\ 6.07	0.06	0.00	0.00	1.99	0.05	0.00	90.00	-1.30
M 1.11 (\ 2.97	0.13	0.00	0.00	1.64	0.04	0.00	90.00	-1.29
M 1.12 (\ 0.00	0.00	0.00	0.00	2.08	0.09	0.00	90.00	2.56
M 1.13 (13.31	-1.07	7.00	15.95	12.53	345.56	0.00	180.00	

Others

No.	xm[m]	ym[m]	zm[m]	Length	Width	z axis	Rotation angle		rho[%]
							L axis	Q axis	
A 1	3.79	0.15	3.53	0.81	7.21	180.00	0.00	0.00	50
A 6	2.98	0.15	3.53	2.93	2.53	180.00	0.00	0.00	50
A 7	2.98	-5.16	3.53	2.93	2.53	180.00	0.00	0.00	50
A 2	3.79	0.15	0.05	0.81	0.65	180.00	0.00	0.00	50
A 3	3.79	-5.14	0.05	0.81	0.65	180.00	0.00	0.00	50
A 4	3.79	-1.77	0.05	0.81	0.65	180.00	0.00	0.00	50
A 5	3.79	-0.22	2.72	0.81	7.26	180.00	0.00	0.00	50
A 2	3.77	-5.09	-0.03	10.50	0.67	0.00	90.00	-0.00	50
A 3	3.77	-1.79	-0.08	10.50	0.67	0.00	90.00	-0.00	50
A 2	14.21	0.26	3.57	14.19	8.00	0.00	90.00	-90.00	50
A 1	7.56	-2.15	0.00	0.48	0.48	0.00	0.00	0.00	50
A 2	7.56	-5.43	0.00	0.48	0.48	0.00	0.00	0.00	50

Object :
Installation :
Project number : ΜΕΤΑΜΟΡΦΩΣΗ ΚΑΘΟΛΙΚΟ
Date : 11.05.2025

2.1 Description, Room 1

2.1.2 Floor plan

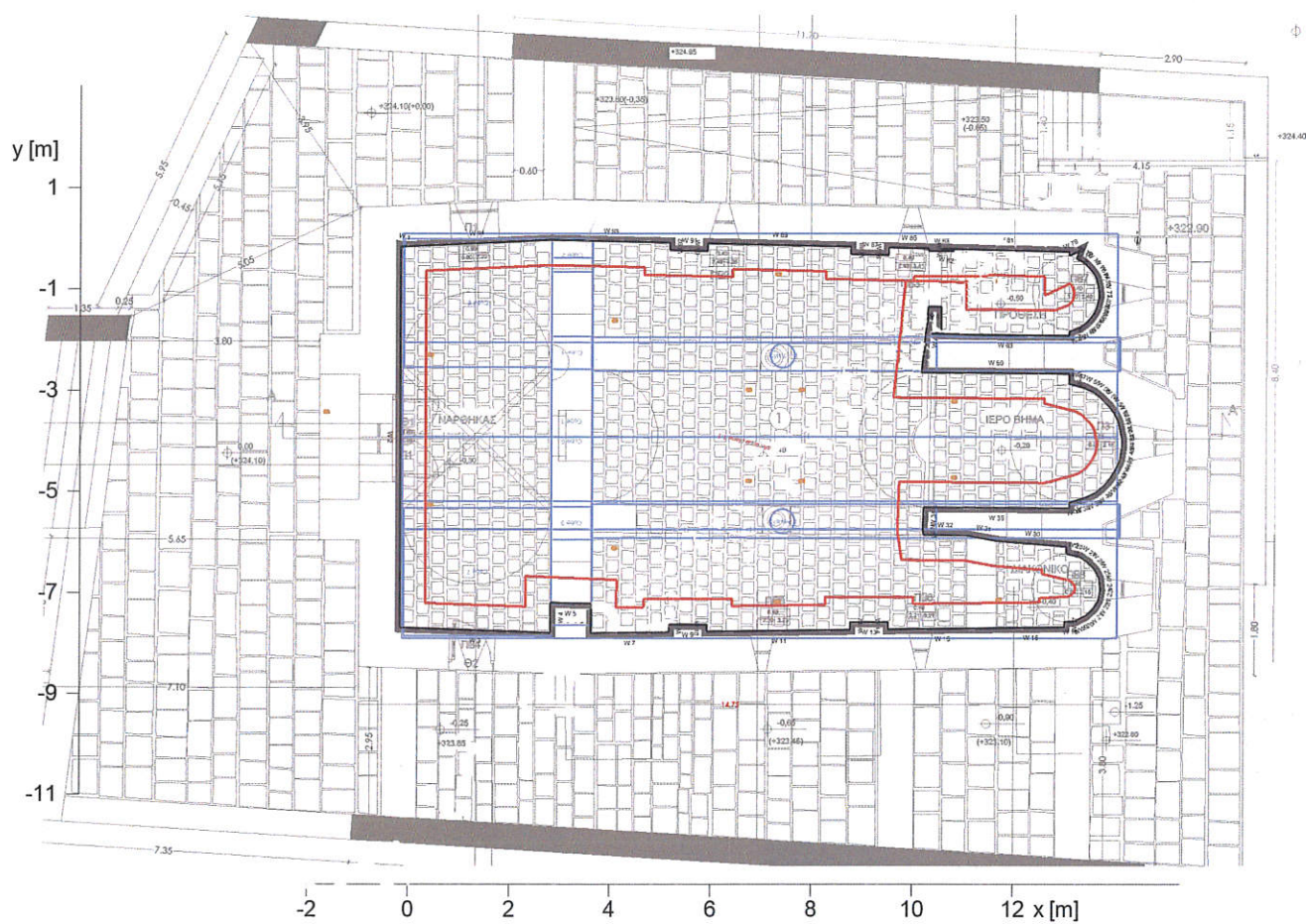

Object :
Installation :
Project number : ΜΕΤΑΜΟΡΦΩΣΗ ΚΑΘΟΛΙΚΟ
Date : 11.05.2025

2.1 Description, Room 1

2.1.2 Floor plan

Wall	x	y	Length	Reflectance
1	8.52 m	13.09 m	0.03 m	50.0 %
2	8.52 m	5.56 m	7.54 m	50.0 %
3	11.52 m	5.45 m	3.00 m	50.0 %
4	11.52 m	6.05 m	0.60 m	50.0 %
5	12.32 m	6.02 m	0.81 m	50.0 %
6	12.32 m	5.45 m	0.57 m	50.0 %
7	13.87 m	5.47 m	1.55 m	50.0 %
8	13.87 m	5.62 m	0.15 m	50.0 %
9	14.61 m	5.62 m	0.75 m	50.0 %
10	14.61 m	5.48 m	0.14 m	50.0 %
11	17.46 m	5.51 m	2.85 m	50.0 %
12	17.46 m	5.66 m	0.15 m	50.0 %
13	18.21 m	5.66 m	0.75 m	50.0 %
14	18.21 m	5.52 m	0.14 m	50.0 %
15	20.36 m	5.55 m	2.15 m	50.0 %
16	21.72 m	5.56 m	1.35 m	50.0 %
17	21.72 m	5.67 m	0.11 m	50.0 %
18	21.92 m	5.68 m	0.21 m	50.0 %
19	21.99 m	5.72 m	0.07 m	50.0 %
20	22.15 m	5.80 m	0.18 m	50.0 %
21	22.31 m	5.95 m	0.22 m	50.0 %
22	22.39 m	6.10 m	0.17 m	50.0 %
23	22.43 m	6.30 m	0.21 m	50.0 %
24	22.40 m	6.54 m	0.24 m	50.0 %
25	22.32 m	6.71 m	0.19 m	50.0 %
26	22.17 m	6.86 m	0.21 m	50.0 %
27	22.02 m	6.96 m	0.18 m	50.0 %
28	21.76 m	7.02 m	0.27 m	50.0 %
29	21.75 m	7.16 m	0.14 m	50.0 %
30	20.36 m	7.27 m	1.99 m	50.0 %
31	19.76 m	7.38 m	0.61 m	50.0 %
32	18.91 m	7.39 m	0.85 m	50.0 %
33	18.90 m	7.50 m	0.11 m	50.0 %
34	18.91 m	7.94 m	0.44 m	50.0 %
35	21.81 m	7.92 m	2.89 m	50.0 %
36	21.81 m	8.03 m	0.12 m	50.0 %
37	21.89 m	8.05 m	0.08 m	50.0 %
38	22.14 m	8.13 m	0.26 m	50.0 %
39	22.31 m	8.21 m	0.20 m	50.0 %
40	22.48 m	8.35 m	0.22 m	50.0 %
41	22.57 m	8.45 m	0.13 m	50.0 %
42	22.63 m	8.52 m	0.10 m	50.0 %
43	22.71 m	8.66 m	0.16 m	50.0 %
44	22.79 m	8.83 m	0.19 m	50.0 %
45	22.81 m	8.88 m	0.05 m	50.0 %
46	22.85 m	9.12 m	0.25 m	50.0 %
47	22.85 m	9.19 m	0.07 m	50.0 %
48	22.85 m	9.30 m	0.11 m	50.0 %
49	22.82 m	9.42 m	0.13 m	50.0 %
50	22.78 m	9.61 m	0.19 m	50.0 %
51	22.75 m	9.69 m	0.09 m	50.0 %
52	22.68 m	9.82 m	0.14 m	50.0 %
53	22.57 m	9.96 m	0.18 m	50.0 %

Object :
 Installation :
 Project number : ΜΕΤΑΜΟΡΦΩΣΗ ΚΑΘΟΛΙΚΟ
 Date : 11.05.2025

2.1 Description, Room 1

2.1.2 Floor plan

54	22.44 m	10.10 m	0.20 m	50.0 %
55	22.30 m	10.21 m	0.18 m	50.0 %
56	22.09 m	10.31 m	0.23 m	50.0 %
57	21.80 m	10.38 m	0.29 m	50.0 %
58	21.80 m	10.58 m	0.20 m	50.0 %
59	18.87 m	10.60 m	2.94 m	50.0 %
60	19.00 m	11.90 m	1.31 m	50.0 %
61	19.25 m	11.90 m	0.25 m	50.0 %
62	19.25 m	11.35 m	0.55 m	50.0 %
63	21.80 m	11.33 m	2.55 m	50.0 %
64	21.80 m	11.41 m	0.08 m	50.0 %
65	22.02 m	11.49 m	0.23 m	50.0 %
66	22.14 m	11.58 m	0.16 m	50.0 %
67	22.22 m	11.67 m	0.12 m	50.0 %
68	22.28 m	11.75 m	0.10 m	50.0 %
69	22.34 m	11.86 m	0.12 m	50.0 %
70	22.36 m	11.96 m	0.10 m	50.0 %
71	22.40 m	12.10 m	0.15 m	50.0 %
72	22.38 m	12.31 m	0.21 m	50.0 %
73	22.34 m	12.46 m	0.15 m	50.0 %
74	22.30 m	12.53 m	0.08 m	50.0 %
75	22.21 m	12.65 m	0.15 m	50.0 %
76	22.09 m	12.77 m	0.17 m	50.0 %
77	21.94 m	12.86 m	0.16 m	50.0 %
78	22.00 m	13.00 m	0.15 m	50.0 %
79	21.80 m	12.91 m	0.22 m	50.0 %
80	21.80 m	12.99 m	0.08 m	50.0 %
81	19.25 m	13.04 m	2.55 m	50.0 %
82	19.50 m	13.00 m	0.25 m	50.0 %
83	19.00 m	13.00 m	0.50 m	50.0 %
84	19.00 m	13.05 m	0.05 m	50.0 %
85	18.21 m	13.07 m	0.79 m	50.0 %
86	18.21 m	12.92 m	0.15 m	50.0 %
87	17.46 m	12.93 m	0.75 m	50.0 %
88	17.46 m	13.08 m	0.15 m	50.0 %
89	14.61 m	13.15 m	2.85 m	50.0 %
90	14.61 m	13.00 m	0.15 m	50.0 %
91	13.87 m	13.02 m	0.75 m	50.0 %
92	13.87 m	13.17 m	0.15 m	50.0 %
93	11.52 m	13.22 m	2.35 m	50.0 %
94	8.55 m	13.09 m	2.97 m	50.0 %
Floor				50.8 %
Ceiling				70.0 %
Room height	7.00 m			
Height of ref. plane	0.75 m			

Object :
Installation :
Project number : ΜΕΤΑΜΟΡΦΩΣΗ ΚΑΘΟΛΙΚΟ
Date : 11.05.2025

2.1 Description, Room 1

2.1.3 3D view, View 1

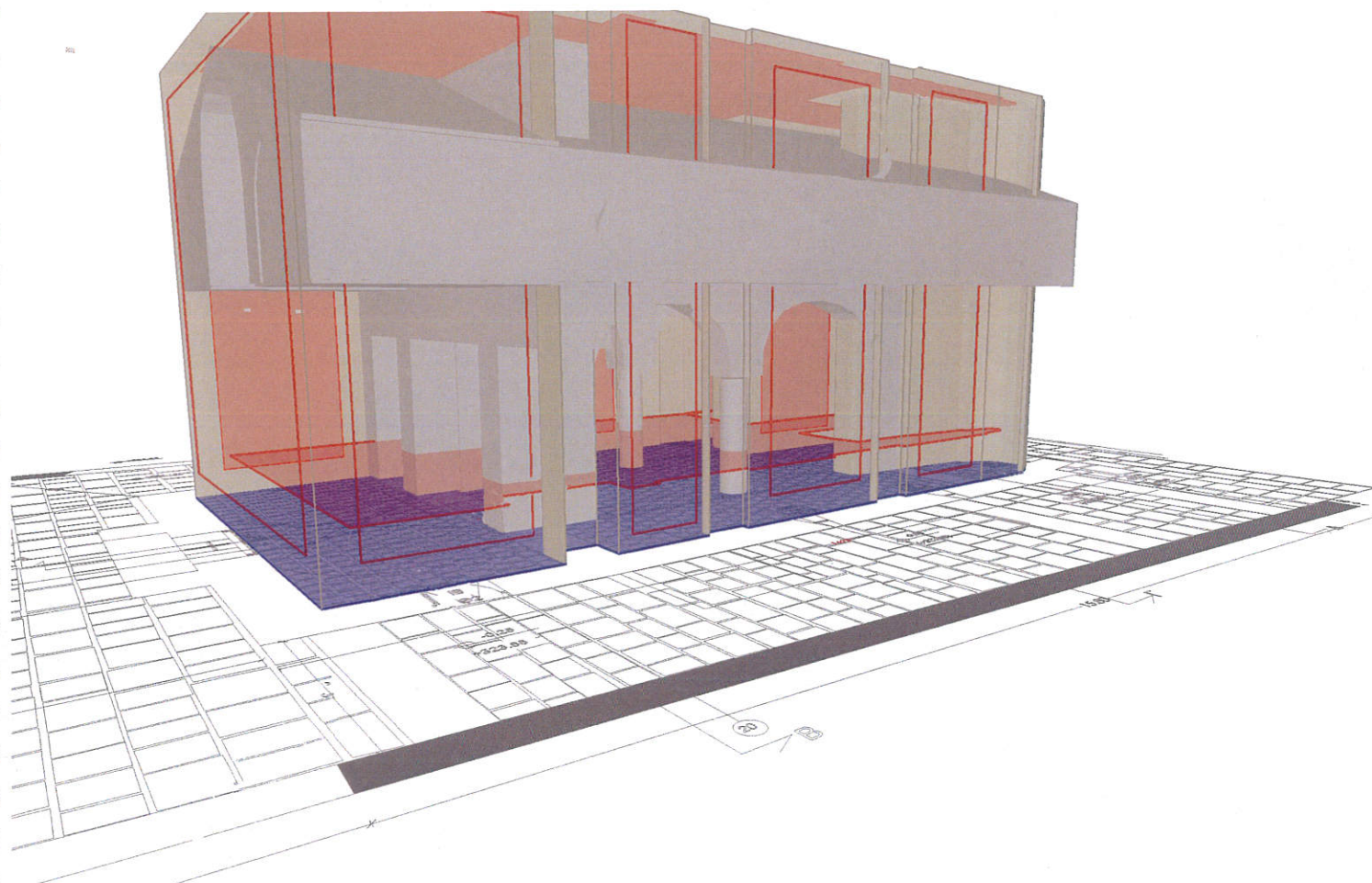

Object :
Installation :
Project number : ΜΕΤΑΜΟΡΦΩΣΗ ΚΑΘΟΛΙΚΟ
Date : 11.05.2025

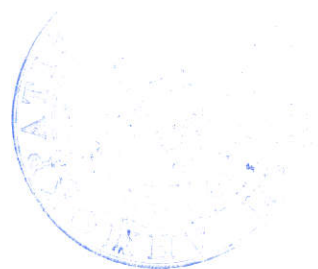

2.1 Description, Room 1

2.1.4 3D view, View from the front

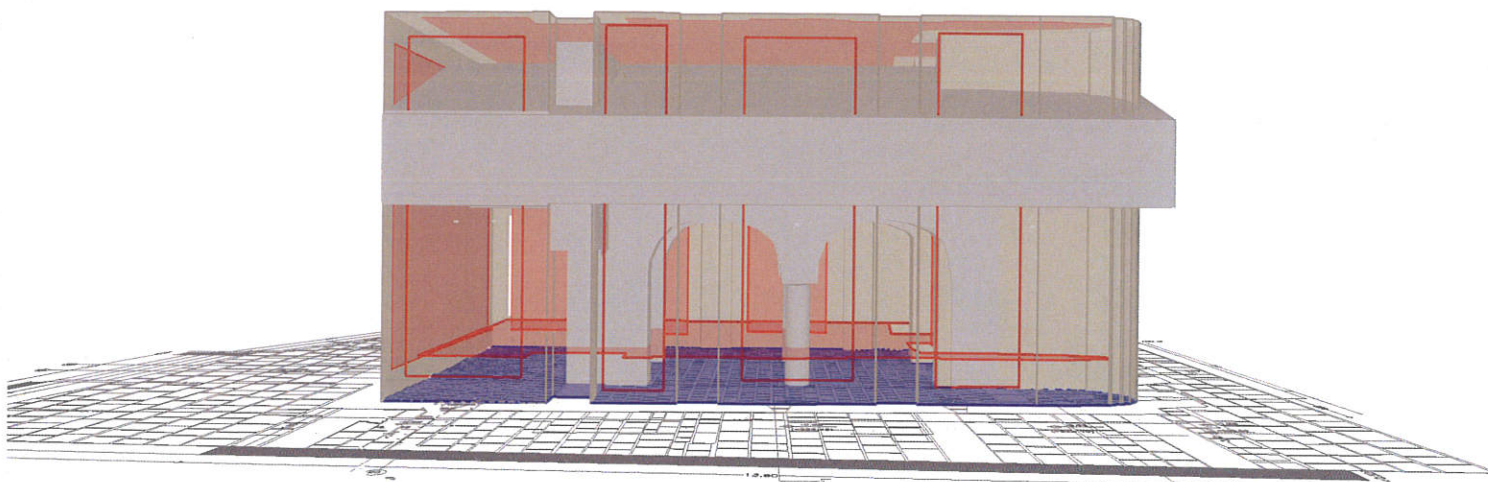

Object :
Installation :
Project number : ΜΕΤΑΜΟΡΦΩΣΗ ΚΑΘΟΛΙΚΟ
Date : 11.05.2025

2.1 Description, Room 1

2.1.5 3D view, View from the left

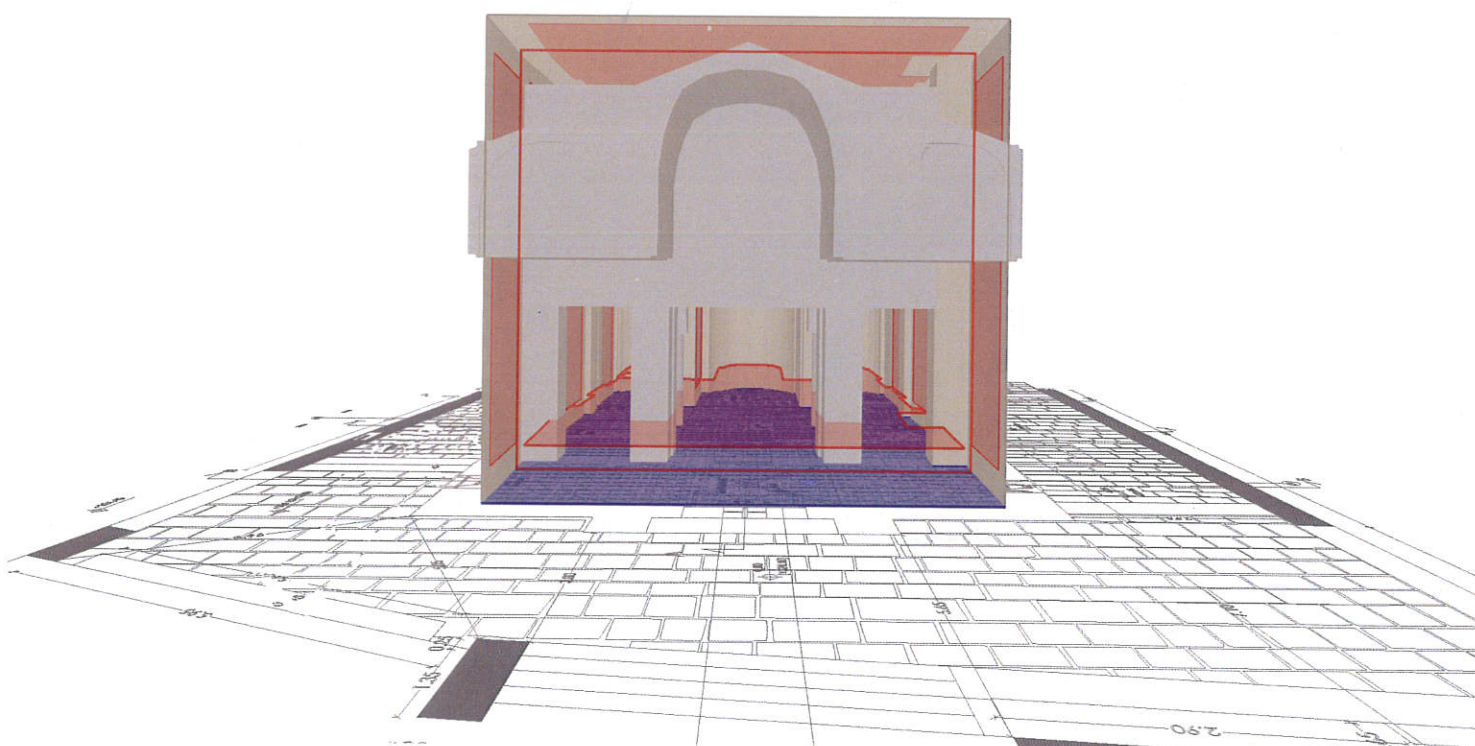

Object :
Installation :
Project number : ΜΕΤΑΜΟΡΦΩΣΗ ΚΑΘΟΛΙΚΟ
Date : 11.05.2025

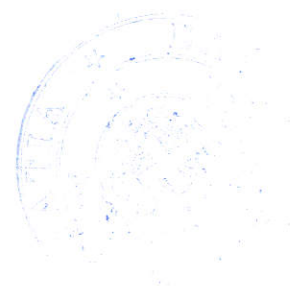

2.1 Description, Room 1

2.1.6 3D view, View from the right

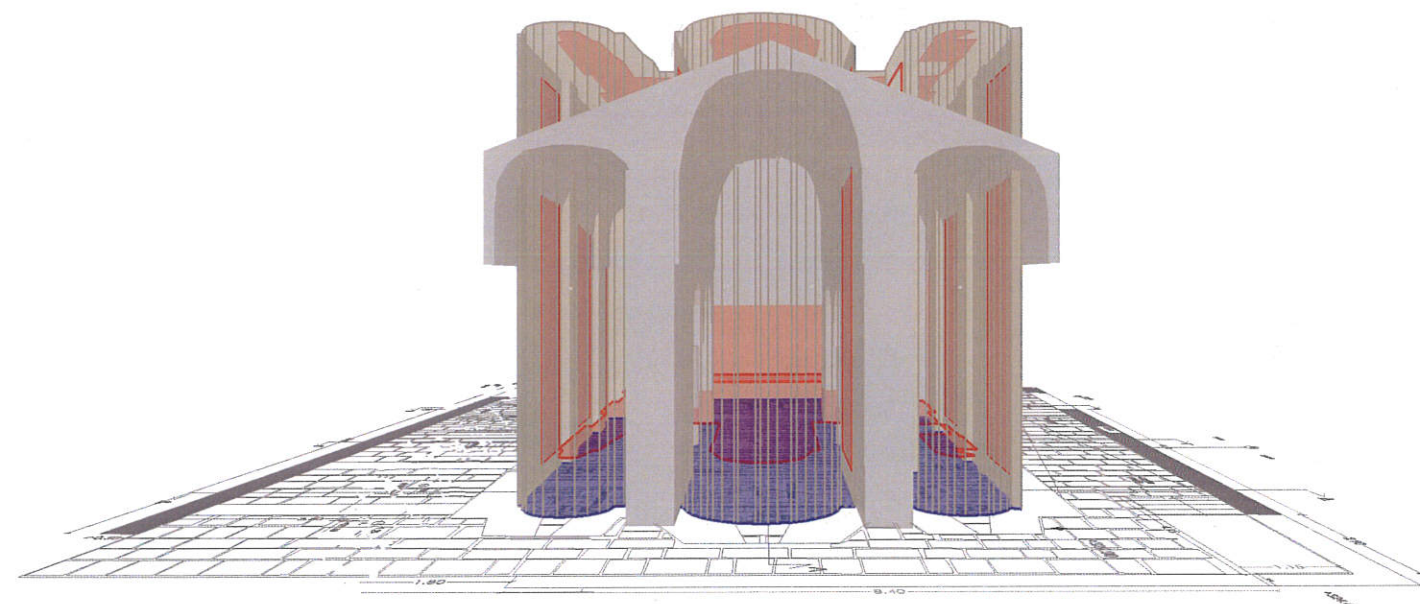

Object :
Installation :
Project number : ΜΕΤΑΜΟΡΦΩΣΗ ΚΑΘΟΛΙΚΟ
Date : 11.05.2025



2 Room 1

2.2 Summary, Room 1

2.2.1 Result overview, Evaluation area 1

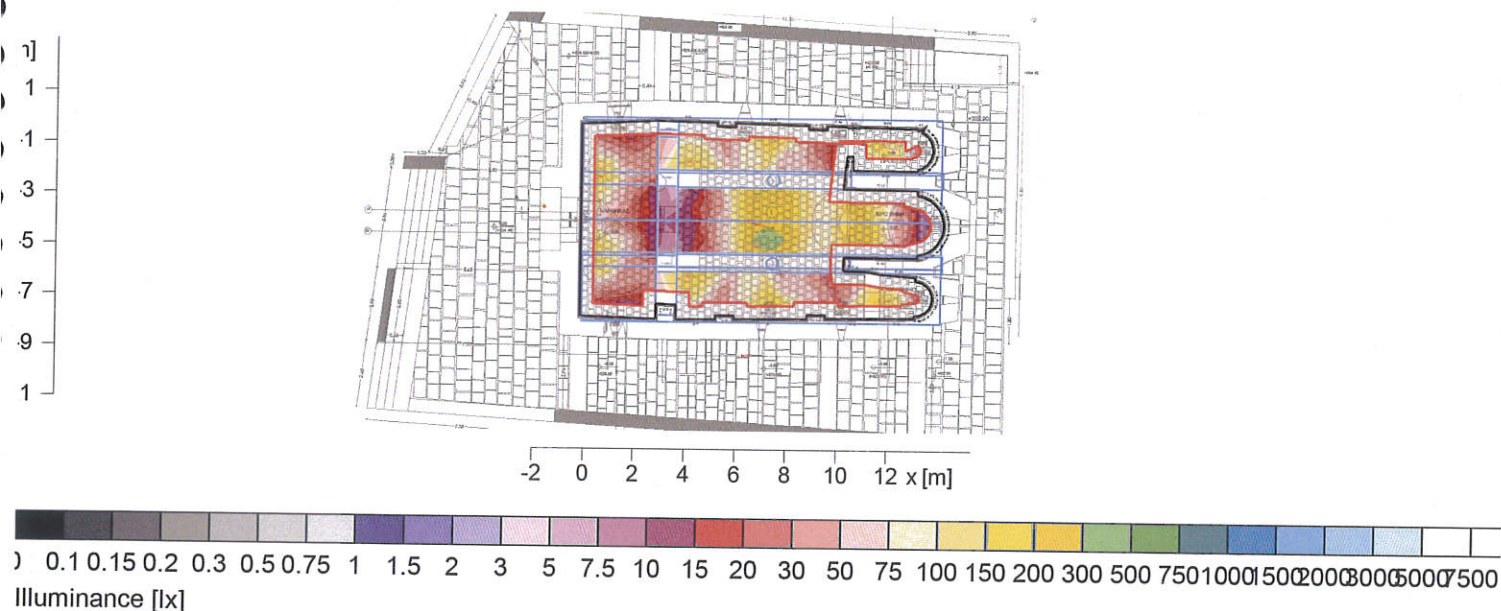

General
Calculation algorithm used
Maintenance factor
Average indirect fraction
0.80
Total luminous flux
11984.00 lm
Total power
126.0 W
Total power per area (99.17 m²)
1.27 W/m² (1.44 W/m²/100lx)

Evaluation area 1	Reference plane 1.1	
Em	Horizontal	cylindrical
Emin	88 lx	28.2 lx
Emin/Em (Uo)	8.9 lx	11.1 lx
Emin/Emax (Ud)	0.10	0.39
Ec/Eh	0.03	
Position	0.75 m	0.30
UGR (--- ---)	=30.0	1.20 m
Luminaire :		
(Product (*4122C* 9Wx856lm) (3))		
Hints:		
- The luminous area is less than 0.005m ² .		

Major surfaces Em Uo

Object :
Installation :
Project number : ΜΕΤΑΜΟΡΦΩΣΗ ΚΑΘΟΛΙΚΟ
Date : 11.05.2025

2 Room 1

2.2 Summary, Room 1

2.2.1 Result overview, Evaluation area 1



Object :
Installation :
Project number : ΜΕΤΑΜΟΡΦΩΣΗ ΚΑΘΟΛΙΚΟ
Date : 11.05.2025

2 Room 1

2.3 Calculation results, Room 1

2.3.1 3D pseudo colours, View 1 (E)

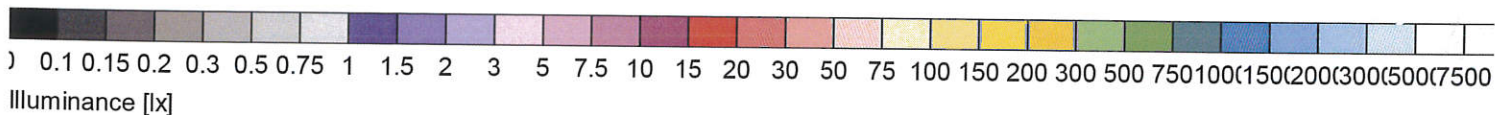
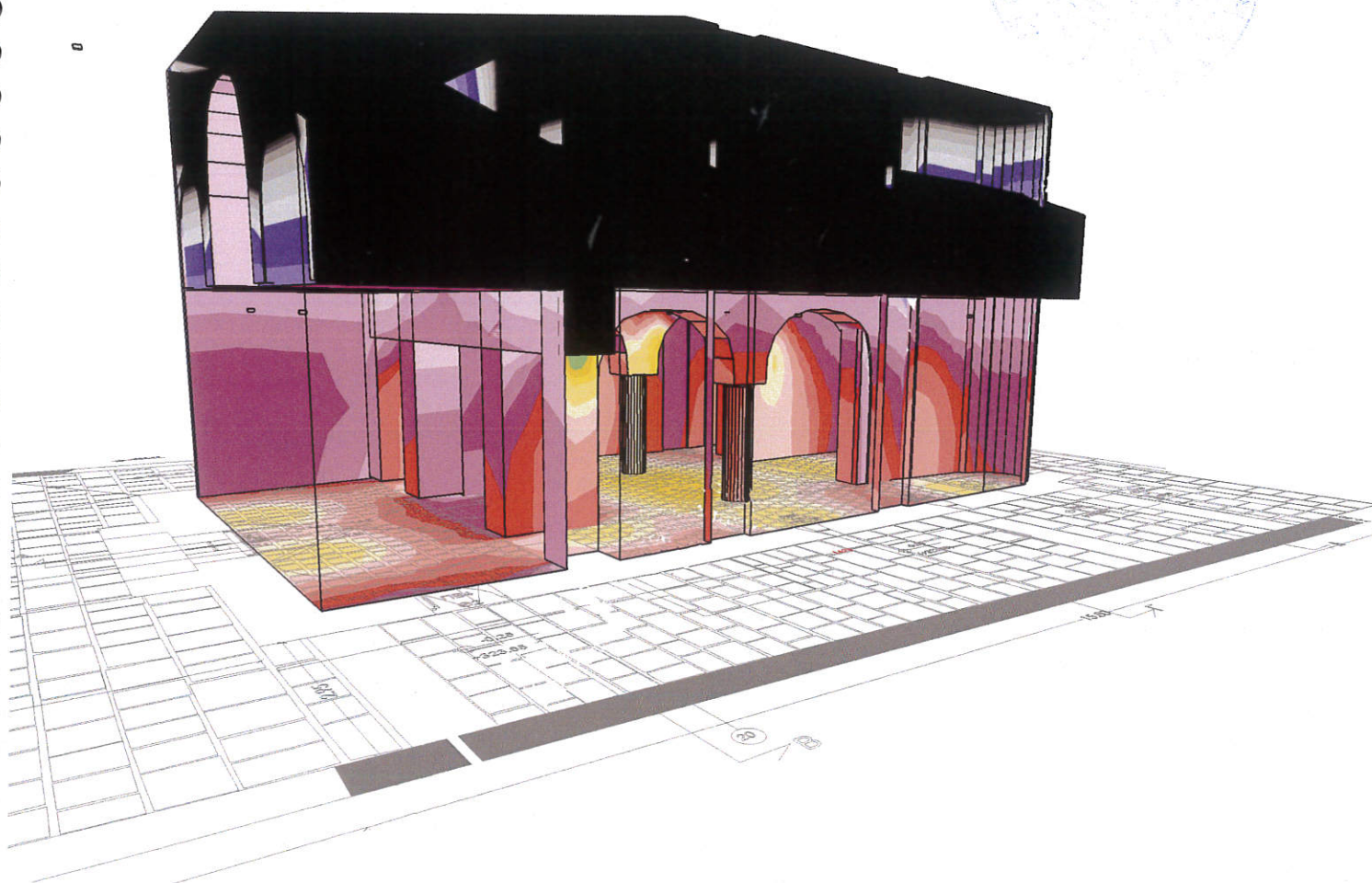

Object :
Installation :
Project number : ΜΕΤΑΜΟΡΦΩΣΗ ΚΑΘΟΛΙΚΟ
Date : 11.05.2025

2.3 Calculation results, Room 1

2.3.2 3D pseudo colours, View from the front (E)

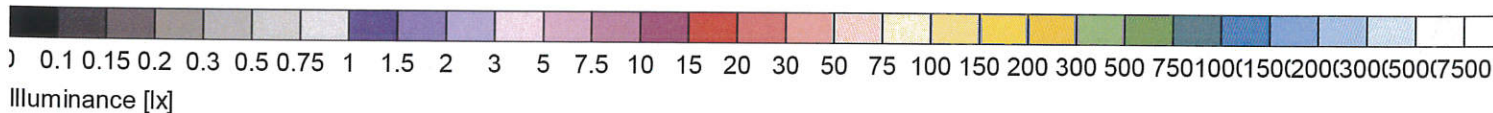
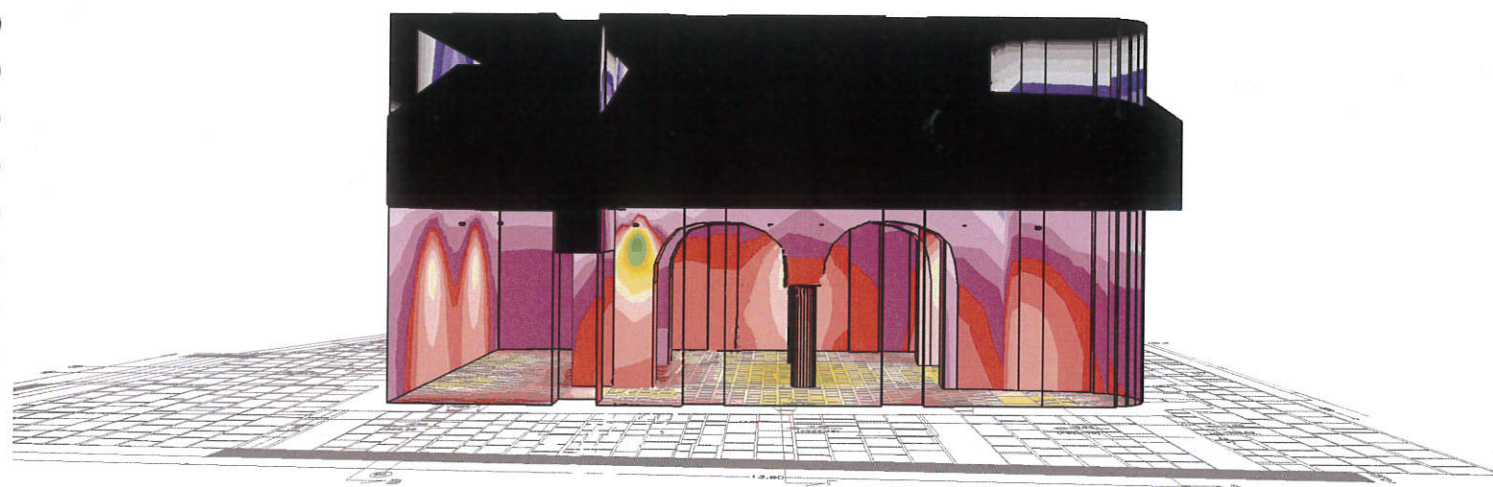

Object :
Installation :
Project number : ΜΕΤΑΜΟΡΦΩΣΗ ΚΑΘΟΛΙΚΟ
Date : 11.05.2025



2.3 Calculation results, Room 1

2.3.3 3D pseudo colours, View from the back (E)

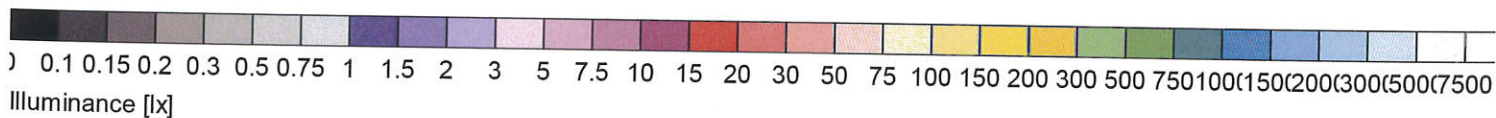

Object :
Installation :
Project number : ΜΕΤΑΜΟΡΦΩΣΗ ΚΑΘΟΛΙΚΟ
Date : 11.05.2025

2.3 Calculation results, Room 1

2.3.4 3D pseudo colours, View from the left (E)

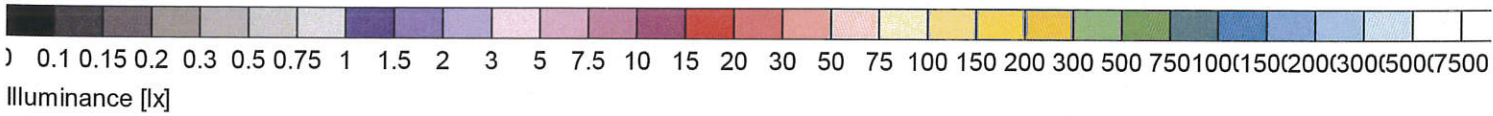
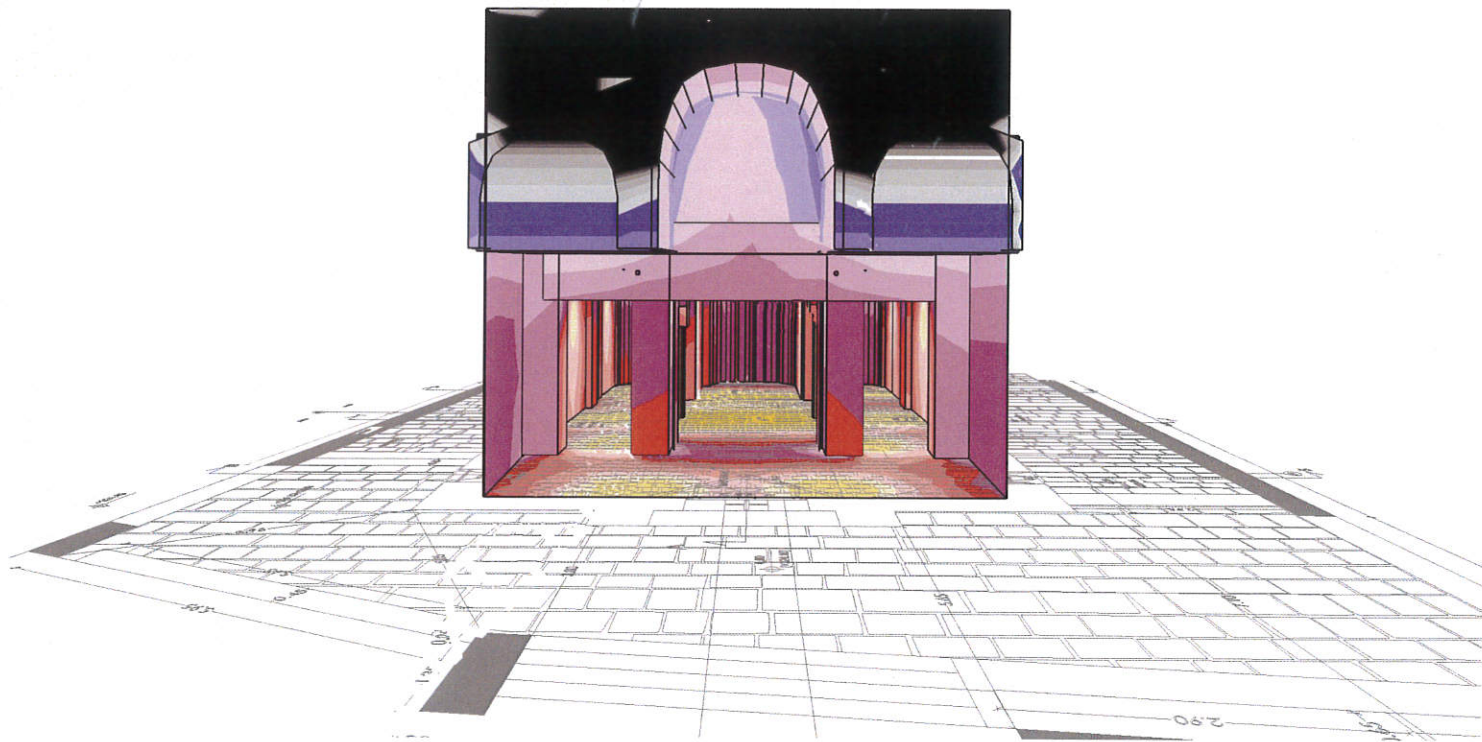

Object :
Installation :
Project number : ΜΕΤΑΜΟΡΦΩΣΗ ΚΑΘΟΛΙΚΟ
Date : 11.05.2025

2.3 Calculation results, Room 1

2.3.5 3D pseudo colours, View from the right (E)

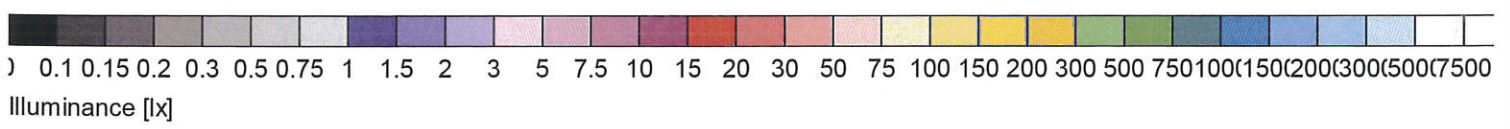
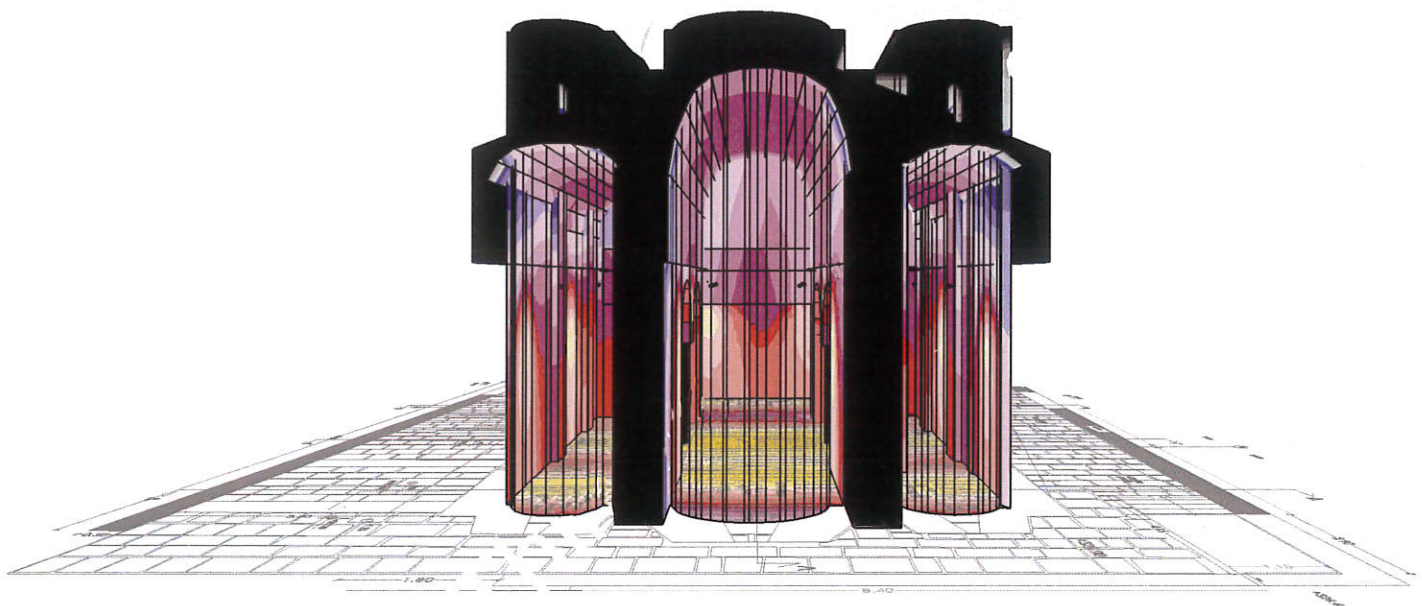

Εικονική απόδοση της στάθμης φωτισμού στο χώρο

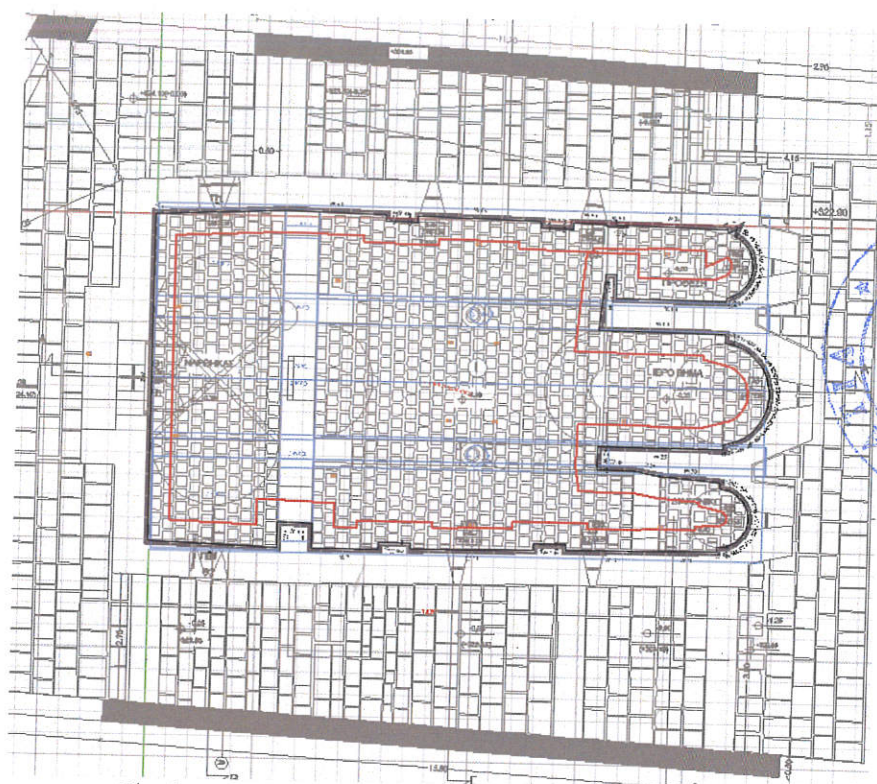

Κάτοψη του Ιερού Ναού στο πρόγραμμα φωτομετρήσεων RELUX

Φωτομετρικά αποτελέσματα

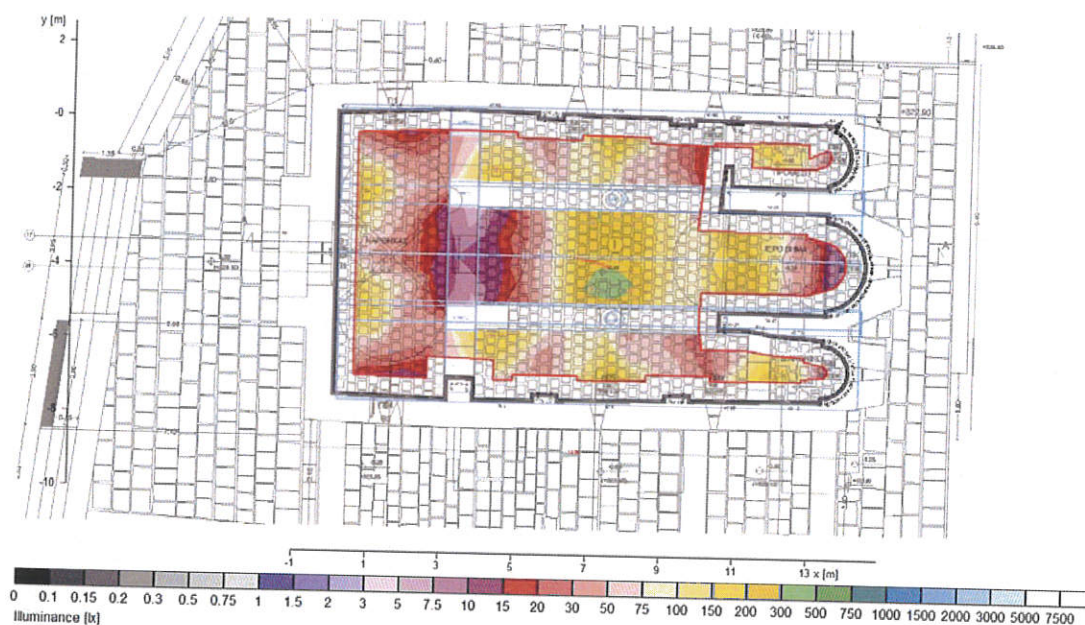

Height reference plane
Average illuminance
Minimum illuminance
Maximum illuminance
Uniformity U_0
Diversity U_d

E_m : 0.75 m
 E_{min} : 88 lx
 E_{max} : 9 lx
 E_{min}/E_m : 285 lx
 E_{min}/E_{max} : 1 : 9.84 (0.10)
 E_{min}/E_{max} : 1 : 31.81 (0.03)

Επιφάνεια υπολογισμού σε ύψος 0,75m

Απεικονίσεις φωτισμού νυχτερινής προσομοίωσης

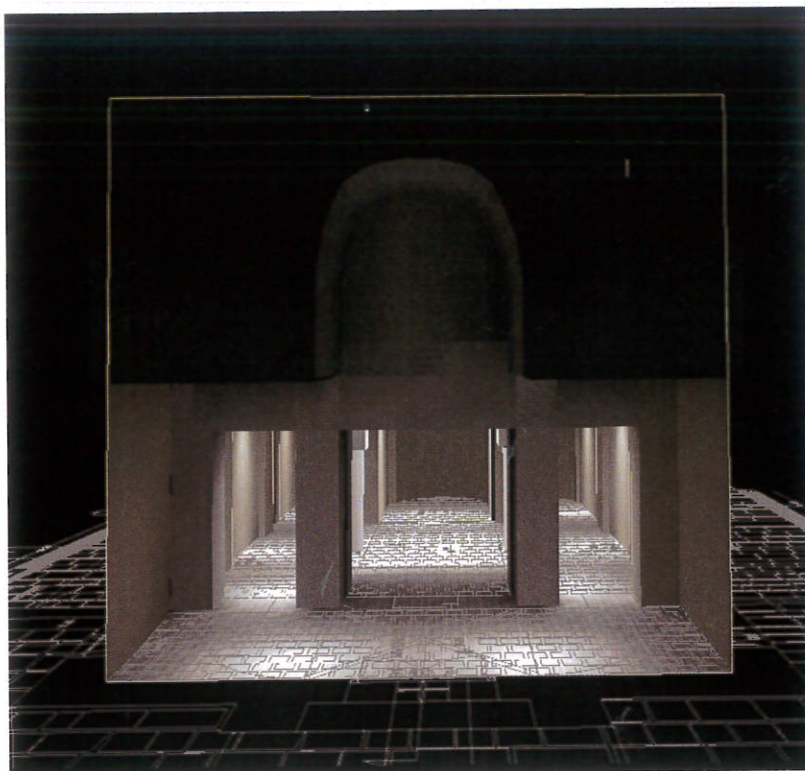

Απεικόνιση 1



Απεικόνιση 2



Απεικόνιση 3



Απεικόνιση 4

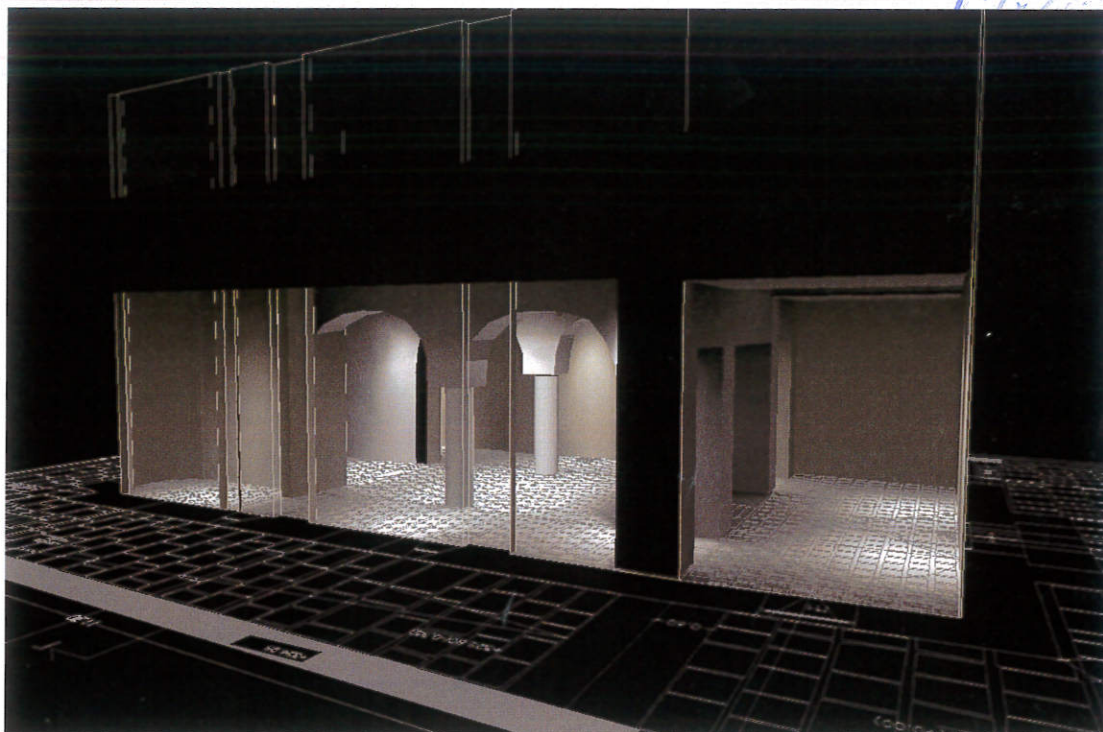

Απεικόνιση 5



Απεικόνιση 6

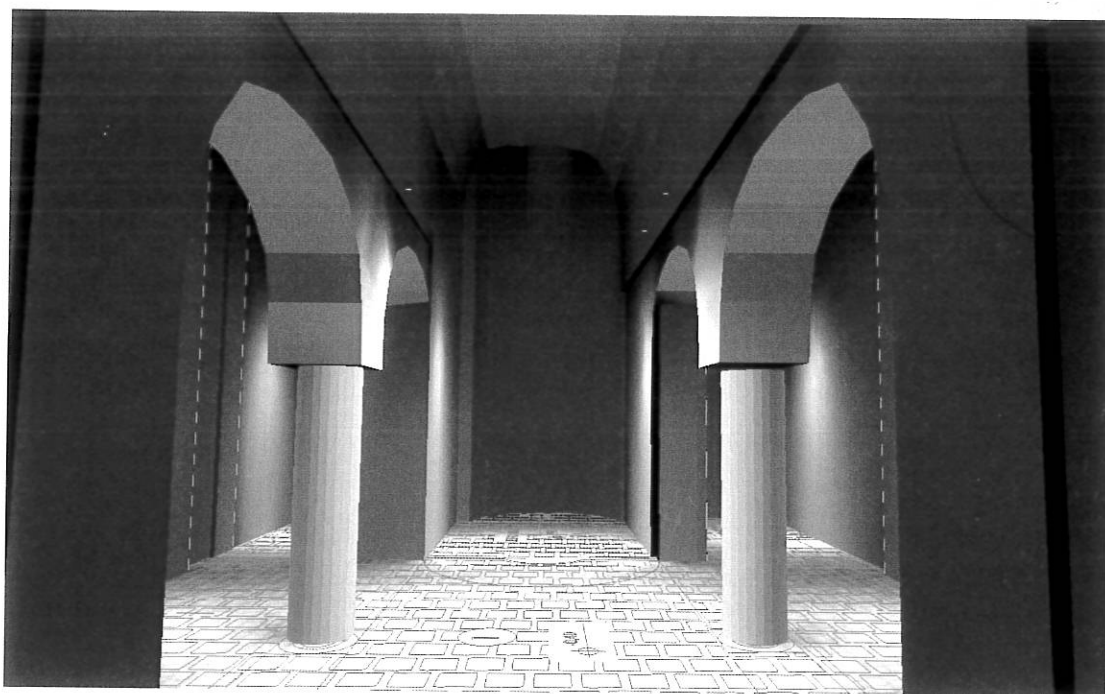

Απεικόνιση 7

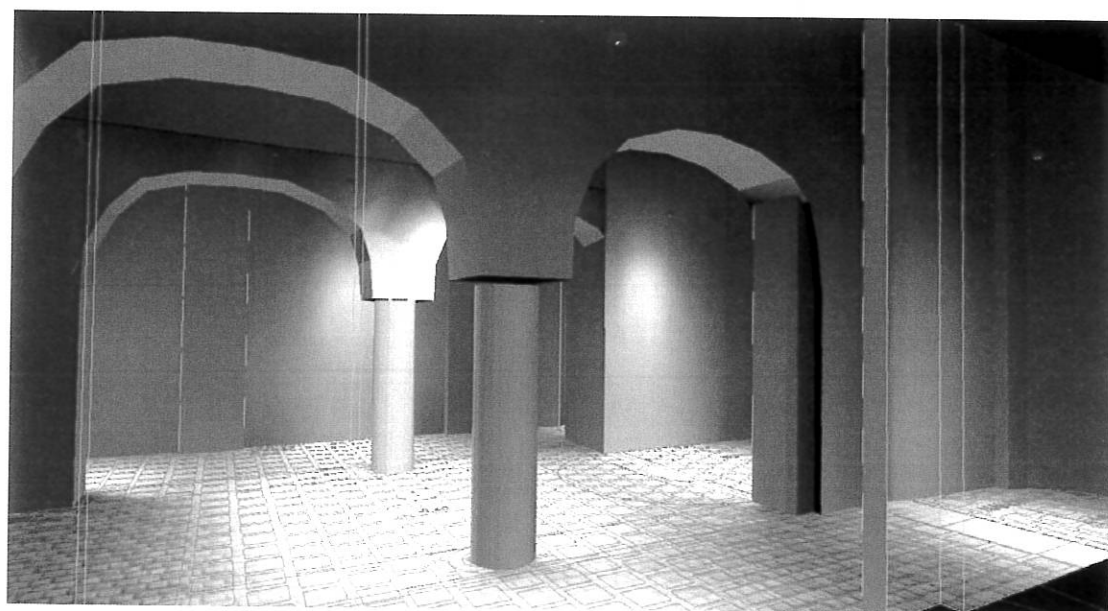

Απεικόνιση 8

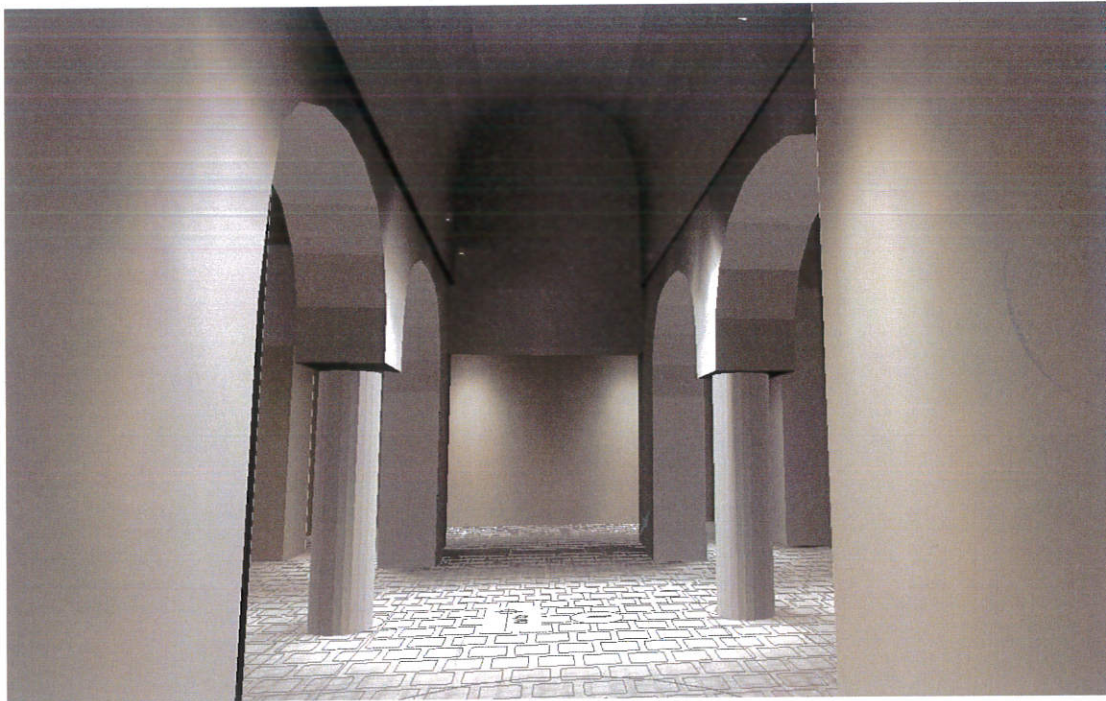

Απεικόνιση 9

ΑΛΕΞΑΝΔΡΟΣ ΣΤ. ΠΑΣΜΑΤΖΙΔΗΣ
ΔΙΠΛ. ΗΛΕΚΤΡΟΛΟΓΟΣ ΜΗΧΑΝΙΚΟΣ & ΜΗΧ. ΚΟΣ Η/Υ
ΠΟΛΥΤΕΧΝΙΚΗΣ ΣΧΟΛΗΣ Α.Π.Θ.
ΜΕΛΟΣ Τ.Ε.Ε. ΑΡΙΘΜΟΣ ΜΗΤΡΩΟΥ: 93091
ΑΓΙΩΝ ΠΑΝΤΩΝ 50 - Τ.Κ. 546 26 ΘΕΣΣΑΛΟΝΙΚΗ
ΤΗΛ 210 506015
ΑΦΜ: 130945058 - ΔΟΥ: Ε' ΘΕΣ/ΝΙΚΗΣ